

EXPLODED PARTS

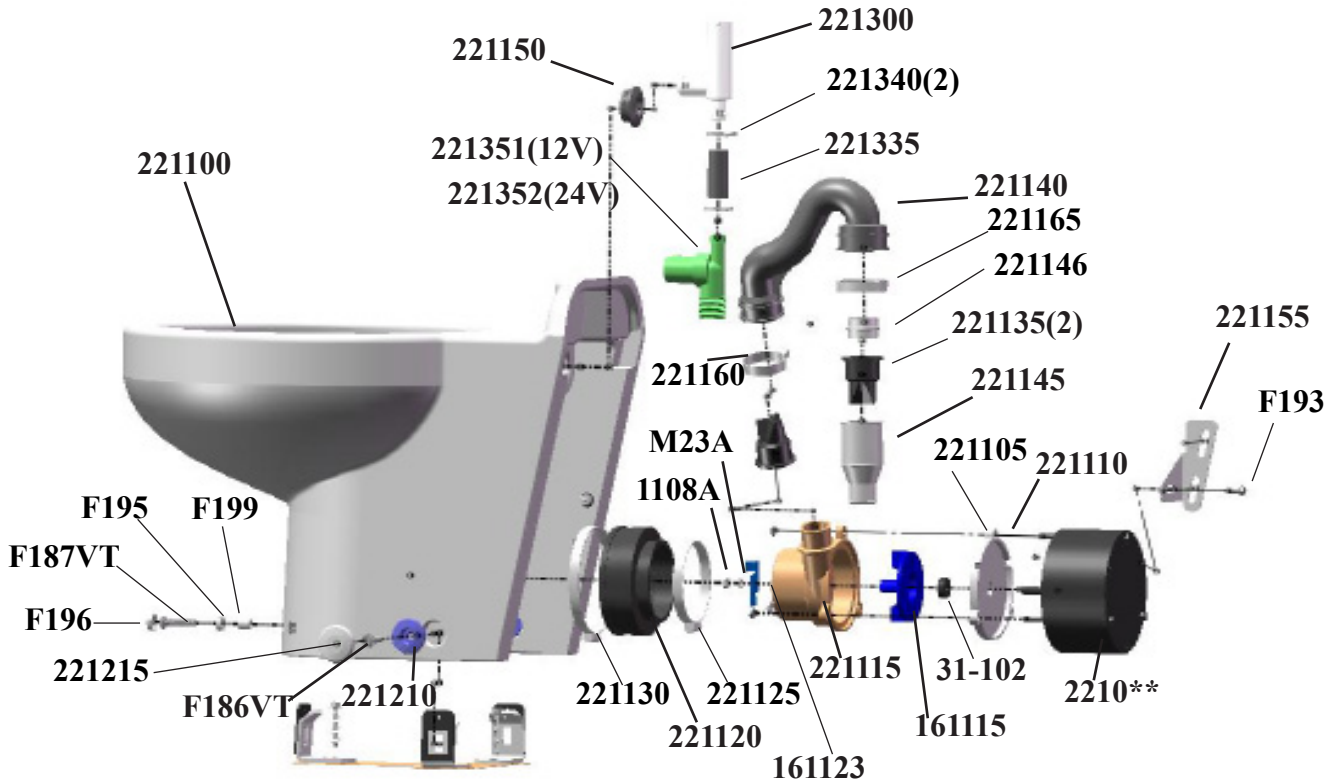

221100	Toilet Bowl,standard, angled, White(1)	F186VT	Bowl Mounting Screw: (2)
221100A	Toilet bowl Bone(1)	F187VT	Bowl Mounting Screw (1)
2210012	Discharge Pump Assembly (1)	F188	Well Nut (2)
221012	MOTOR: 12 VDC (1)	F189	Deck Mounting (3)
221024	MOTOR: 24V DC (1)	F193VT	Pump Mounting (1)
221105	O-RING (1)	F195	Front mounting washer (1)
221110	Discharge Pump Seal Plate (1)	F196	Front mounting snap cap (1)
221115	Discharge Pump Macerator Housing(1)	M23A	Lockwasher
221120	Bowl Throat Adapter (1)	166000	Remote pump complete 12v
221125	Bowl Throat Adapter Clamp (small)(1)	166100	Remote pump complete 24V
221130	Bowl Throat Adapter Clamp - Large (1)	1660**	Motor, raw water pump
221135	JOKER VALVE (Custom) (2)	161115	Impeller
221140	Discharge Hose (Custom)(1)	161123	Macerator Blade
221145	Discharge Adapter Fitting(1)	162135	Cone Seal
221150	Uni Seal 1/2" (1)	162225	O-Ring
221155	Discharge Pump Mounting Bracket(1)	162305	Lower Housing includes #162315
221156	Discharge Mtg Bracket Straight Back Model	162310	Diaphragm includes #162315
221160	Discharge Hose Clamp - Small (1)	162315	Piston (4)
221165	Discharge Hose Clamp - Large (1)	162320	Piston Seat (4) includes #162315
221170	Discharge hose strap(not shown)	162325A	Bearing Plate Assembly includes #162315
221175	L bolts2(2) (not shown)	162405	3/4" Hose Barb - 90° Fitting
221210	Bowl Mounting Bushing (2)	162410	3/4" Hose Barb - Straight Fitting (2)
221215	Bowl Mounting Bushing Cap (2)	162415	Plug Fitting
221300	Vacuum Breaker Assembly 1	162420	Fitting Clip (3)
221325	Vacuum Breaker Seal Washer (1)	162425	Fitting O-Ring (4)
221330	Vacuum Breaker O-Ring (#16)(1)	F005	Set Screw
221351	Water Solenoid Valve (12V)(1)	F172	Piston Fastener (4)
221352	Water solenoid valve (24V)(1)	F144	Mounting Bolt Washer (4)
221355	Water Line Adapter (1)	F162VT	Mounting Bolt
221335	1/2" Hose 2.25" L (1)	F199	Bushing
221340	1/2" Clamps (2)	1108A	Nut
31-102	Motor Shaft Seal		
31-114	Lock Nut 10-32 W/Nylon (3)		
CH20B	#10 Lock washer (not shown)		
F321	Fender washer (not shown)		

TROUBLESHOOTING

TROUBLESHOOTING

WARNING: HAZARD OF ELECTRIC SHOCK - Before beginning any work on the toilet, be sure that all power to the unit has been turned off.

WARNING: HAZARD OF FLOODING - Make sure seacocks are in the CLOSED or OFF position before working on toilet.

NOTE: The following information reflects the most probable causes and solutions to problems although not every possible cause and solution is provided.

Any questions regarding servicing or operation of the Marine Elegance should be directed to our Technical Support Department in Millville, NJ or Ft. Lauderdale, FL. Please have model and serial number available before calling.

PROBLEM	POSSIBLE CAUSE	SOLUTION
1. Poor pumpout, especially solids.	1A. Clogged discharge line. 1B. Plumbing restrictions, bends and ells. 1C. Clogged vents. 1D. Mineral buildup in hoses and fittings. 1E. Low voltage.	1A. Be sure discharge seacock is open. Clear line, remove clog. 1B. Replumb to eliminate bends and ells. 1C. Clean holding tank vent and vented loop vents 1D. Clean or replace affected parts. Replace hose if needed. 1E. Check voltage at toilet while toilet is running . If less than nominal voltage of toilet (12 or 24), check condition of batteries and wire sizes. Check terminals and wire connections for corrosion (heat at terminals and junctions indicates a bad or corroded connection).
2. Poor water flow, especially at front of bowl (or no water flow).	2A. Toilet not level. 2B. Restriction in intake line. 2C. Pump sucking air. 2D. Low voltage. 2E. Clogged strainer.	2A. Raise rear of toilet; check with level. 2B. Be sure seacock is open. Clear line-remove clog. 2C. Check all connections from intake thru-hull to intake pump to be sure no air leaks are present. 2D. See 1E, above. 2E. Remove or Clear debris from strainer.
3. Foul odors from toilet area.	3A. "Marine life" lodged in rim of bowl. 3B. Permeated discharge hose. 3C. Sewage remaining in discharge line.	3A. Remove and flush bowl with pressure hose to remove all material. Install strainer in intake line to avoid recurrence. 3B. Replace hose with Raritan sanitation hose (#SH). 3C. Flush toilet longer; replace hose if permeated; reroute hose making a shorter run if possible.
4. Bowl fills while underway.	4A. Pressure buildup at seacocks.	4A. Close intake, then discharge seacock to determine which is causing problem. If discharge, be sure the vent or vented loop is clean. If intake, there is too much pressure on seacock; contact Raritan Technical Support.
5. Water leaking from under unit.	5A. Leaking Bowl Throat adapter. 5B. Leak at shaft seal. 5C. Leak from bowl spud.	5A. Tighten adapter clamps. 5B. Check seal and motor shaft. 5C. Check and reseal bowl grommet

